



# 301 CONCORD STREET

PAWTUCKET, RI

FOR LEASE | 2,000 SF - 15,800 SF AVAILABLE ON 9.02 ACRES

CHRIS MICHNIEWICZ  
DAVID BERMAN

774.994.1698  
413.636.9055

chris@stubblebinecompany.com  
dberman@stubblebinecompany.com



THE  
STUBBLEBINE  
COMPANY

CORFAC INTERNATIONAL

# PROPERTY SUMMARY



## PROPERTY HIGHLIGHTS

- 6 GROUND LEVEL DOORS (EXPANDABLE)
- CITY/WATER/SEWER
- 16' CLEAR HEIGHT
- VISIBILITY FROM I-95
- EASY ACCESS TO HIGHWAY

## OFFERING SUMMARY

Lease Rate:	MARKET
Available SF:	2,000 - 16,800 SF
Contiguous Space:	2,000 SF - 10,800 SF
Lot Size:	9.02 Acres
Building Size:	66,400 SF

DEMOGRAPHICS	3 MILES	5 MILES
Total Households	9,775	75,165
Total Population	23,952	193,604
Average HH Income	\$51,964	\$58,414

# ADDITIONAL PHOTOS



# FLOOR PLAN



# FLOOR PLAN

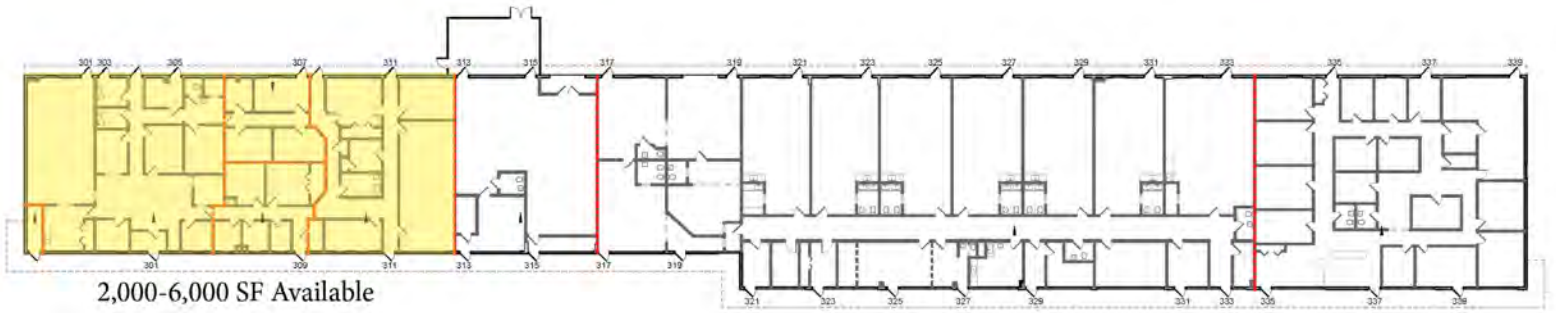

# LOCATION MAP

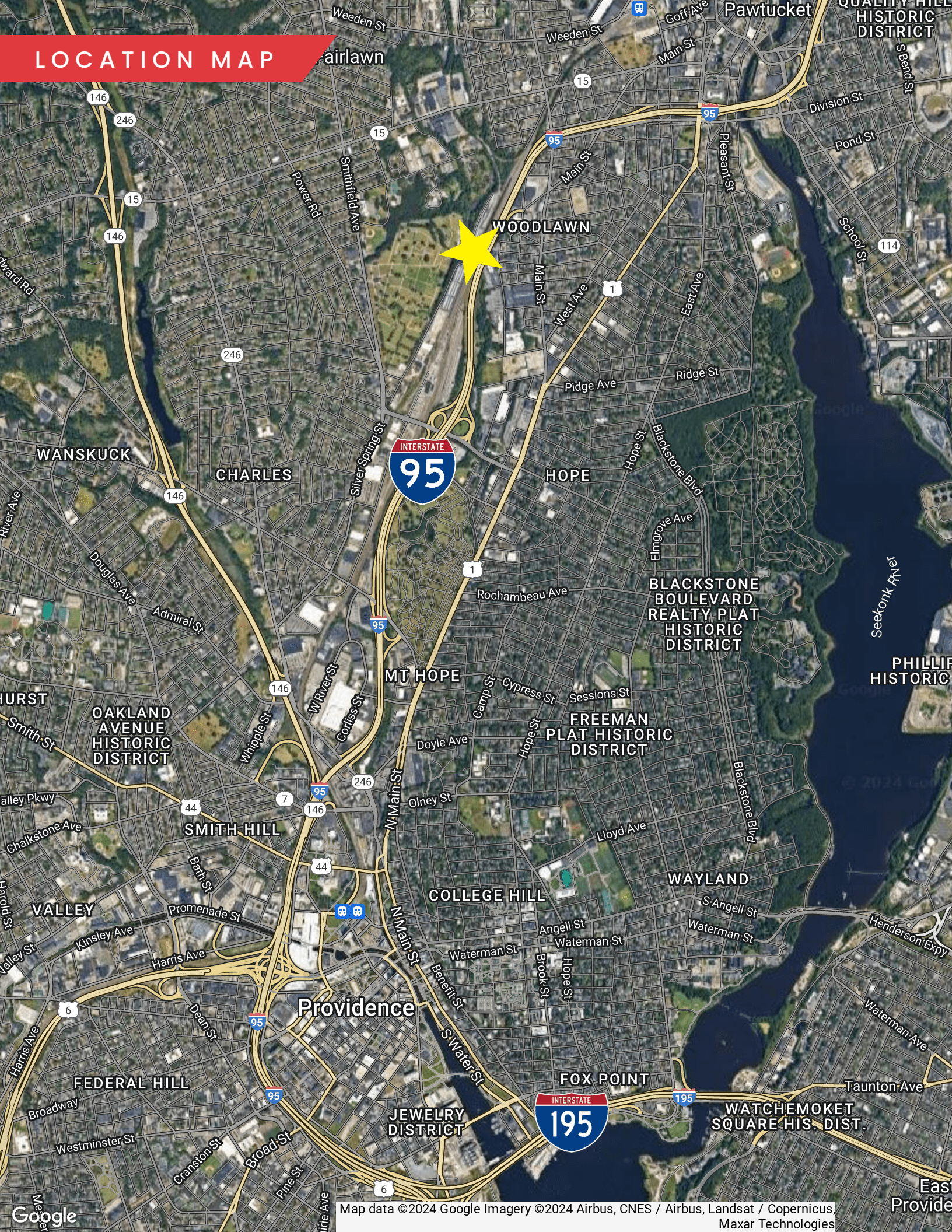

# 301 CONCORD STREET

PAWTUCKET, RI

FOR LEASE | 2,000 SF - 15,600 SF AVAILABLE ON 9.02 ACRES

**CHRIS MICHNIEWICZ**  
774.994.1698  
chris@stubblebinecompany.com

**DAVID BERMAN**  
413.636.9055  
dberman@stubblebinecompany.com

We obtained the information above from sources we believe to be reliable. However, we have not verified its accuracy and make no guarantee, warranty or representation about it. It is submitted subject to the possibility of errors, omissions, change of price, rental or other conditions, prior sale, lease or financing, or withdrawal without notice. We include projections, opinions, assumptions or estimates for example only, and they may not represent current or future performance of the property. You and your tax and legal advisors should conduct your own investigation of the property and transaction.



THE  
STUBBLEBINE  
COMPANY

CORFAC INTERNATIONAL